

.159 hole is threaded  
10-32 for set screw that  
retains Lead Screw.

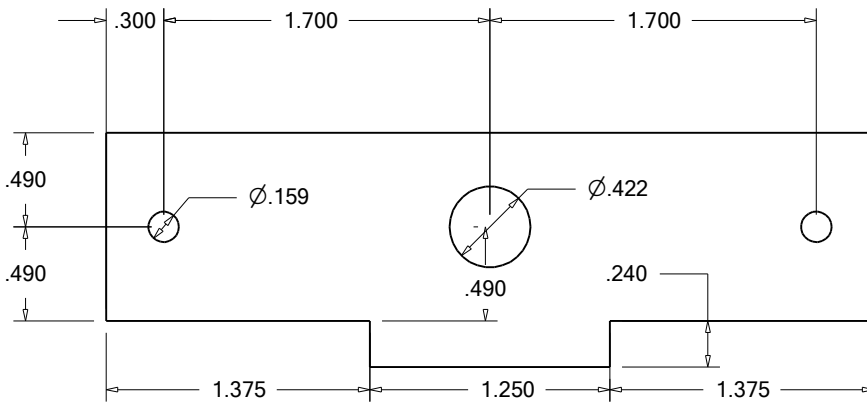

.422 hole is thru entire Jaw and  
threaded for 1/2-13 Lead Screw.  
Lead Screw is retained with 10-32  
set screw.

.159 holes threaded for Jaws.  
10-32 Allen Cap Head screws.

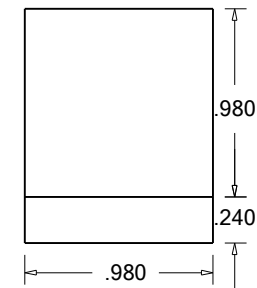

The only difference between this Moveable Jaw and the Bar Stock Version is the depth of the guide extension. Here it is shown as 0.240 for the milled version but will be 0.365 for the Bar Stock Version.